

RIVERSIDE INDUSTRIAL PARK—BUILDING 27 & 42



**BUILDING INFORMATION**

Utilities: Water: 10 inch main  
 Sewer: 8 inch main  
 Sprinkler: Dry  
 Electric: 3 phase, 480/277 volt  
 1500KVA and 150 KVA services  
 Gas: 2 inch (25-30 psi)

Ceiling Height: 26 ft ceiling  
 24 ft clear height

Roof Material: Steel decking with membrane

Docks: (9) 8 ft wide, elevated  
 (5) 10 ft wide, elevated

Heat: Some radiant heating at specific locations

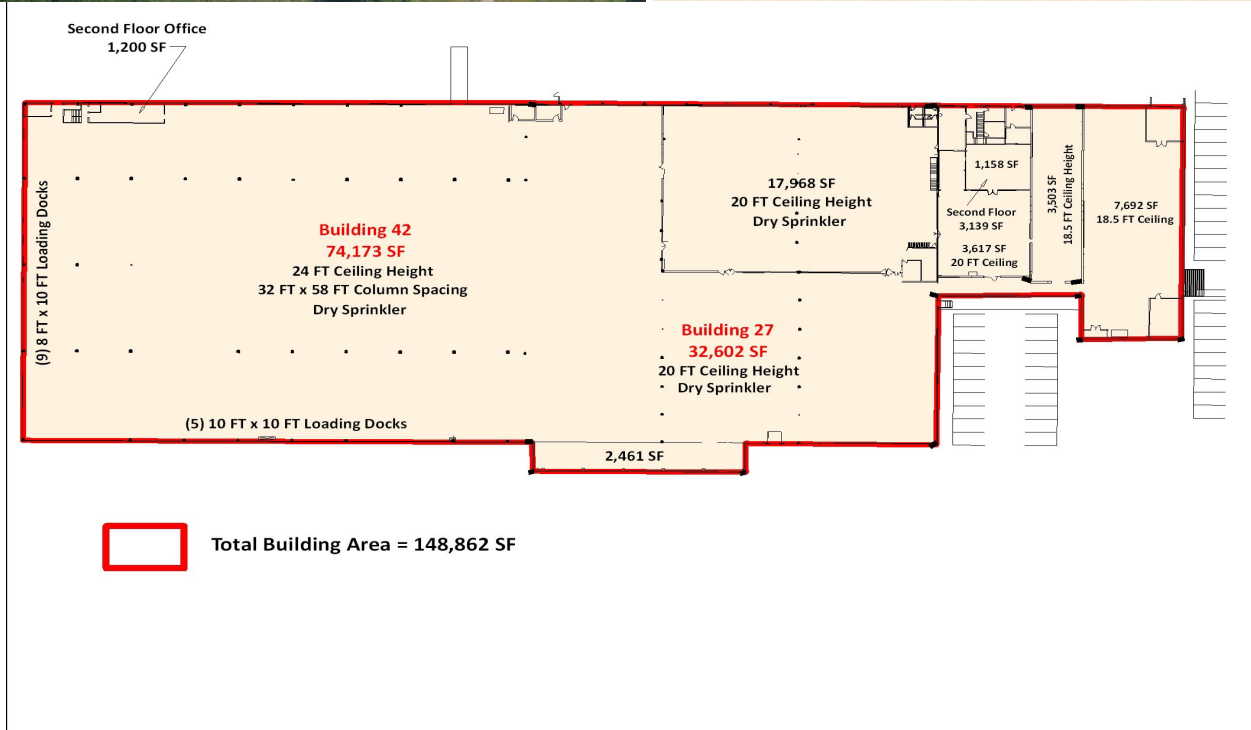

**ALLEGANY COUNTY DEPARTMENT OF  
 ECONOMIC & COMMUNITY DEVELOPMENT**

Jeffrey Barclay, Acting Director  
 701 Kelly Road, Suite 400  
 Cumberland, Maryland 21502  
 Phone: 800-555-4080 Fax: 301-777-2194  
 Website: [www.alleganyworks.org](http://www.alleganyworks.org)