



BARTON BUSINESS PARK SHELL BUILDING

Barton Business Park is located adjacent to Orbital ATK, Allegany Ballistics Laboratory, part of the company’s Tactical Propulsion and Controls Division, in nearby Rocket Center, West Virginia. The **American Woodmark Corporation™**, third largest manufacturer of kitchen and bath cabinets in the United States, opened a 250,000 square foot assembly facility at Barton Business Park in 2004 and was the Park’s first tenant.

The Barton Business Park 40,000 square foot shell building was completed in the summer of 2017 and is County owned. Will consider Lease, Lease/Purchase, or Purchase for projects with a significant job component. Take the guess work out of your next location. Contact us today!

SHELL BUILDING SPECIFICATIONS

- 40,000 sf (200 ft x 200 ft), expandable to 80,000 sf
- Construction: Pre-Engineered Metal Building (Butler Manufactured) with block wall exterior on three sides to 8 ft 8 inches, with split face on the outside. Back wall is expandable
- 24 ft ceiling height in the center and 15 ft at the eaves
- 12:1 pitch metal roof, one center column
- 6 inch concrete floor
- (6) 9 ft truck doors with auto-levelers and (1) at grade
- Duplex grinder pump, 3 inch pressure sewer
- Natural gas infrared radiant heat
- 3 phase 277/480 electric, 800 amp service with a 500 KVA transformer
- Dry water sprinkler system throughout

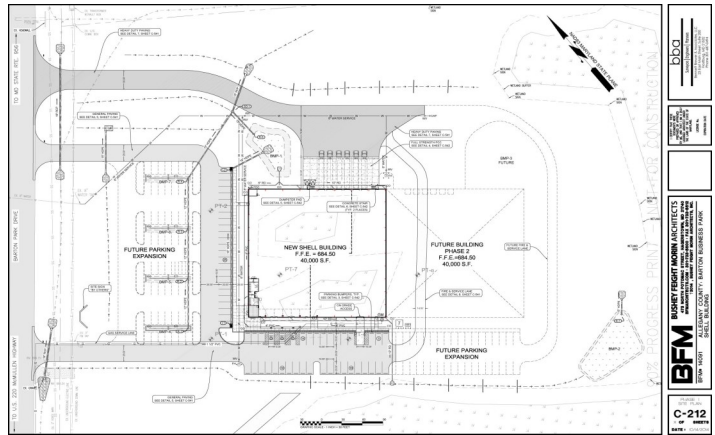

REGION DEMOGRAPHICS

Within a 25 mile radius from the Barton Business Park:

Population:	146,453
Average Household Income:	\$31,749
Households:	57,182
Civilian Labor Force:	65,727

CONTACT INFORMATION

ALLEGANY COUNTY DEPARTMENT OF ECONOMIC & COMMUNITY DEVELOPMENT

Jeffrey S. Barclay, Director
 701 Kelly Road, Suite 400
 Cumberland, Maryland 21502
 Phone: 800-555-4080 Fax: 301-777-2194
 jbarclay@alleganygov.org
 www.alleganyworks.org



**ALLEGANY COUNTY
 DEPARTMENT OF ECONOMIC
 & COMMUNITY DEVELOPMENT**